



# 8X20 OFFICE

MBM0820

## A WORK SPACE BUILT TO MOVE

A BigSteelBox Office is much more durable and secure than a wood frame trailer. The 8' x 20' Office is our most common size and we usually have stock available for sale or rent. Because it is stackable and easy to move, this office is ideal for sites where space is at a premium.

### SPECIFICATIONS

- 8'(w) x 20'(l) x 8'6(h) corten steel shell is durable and easy to transport
- Working cargo doors with lock box for ease of loading and unloading furniture
- (1) powder coated steel man door with deadbolt and lock box for added convenience and security
- (1) 4' x 3' powder coated sliding window with vandalism guard to protect the glass
- Durable rubber baseboards to protect the walls from spills
- Hardwood container flooring is durable and easy to maintain
- 1/2" spray foam with fiberglass insulation (R15) to regulate temperatures
- Framed walls with 2"x4" wood studs and 1/2" vinyl-wrapped drywall to create a brighter and more comfortable workspace
- (2) 2000w wall-mounted heaters with thermostat to warm the office while maximizing space
- (1) 6000BTU air conditioning unit to quickly cool and create a comfortable workspace
- Exterior photocell light for safety and security
- Interior vapor-proof lighting for added moisture resistance and durability
- 100 amp panel with breakers & hard wire fitting for easy connection to a 120/240V 30amp power source
- Telephone & data hookups for fast connectivity
- (1) Quad and (4) duplex receptacles to power your devices

**ALBERTA BUILDING CODE  
PART 10 CERTIFICATION  
AVAILABLE UPON REQUEST.**

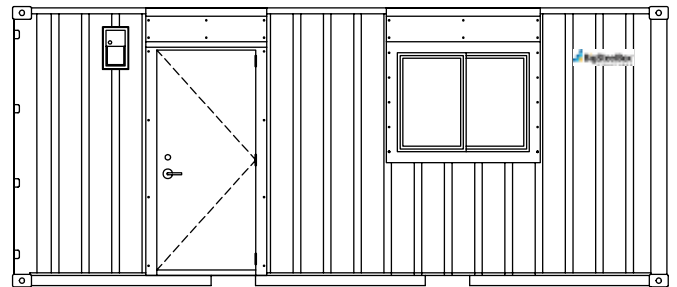
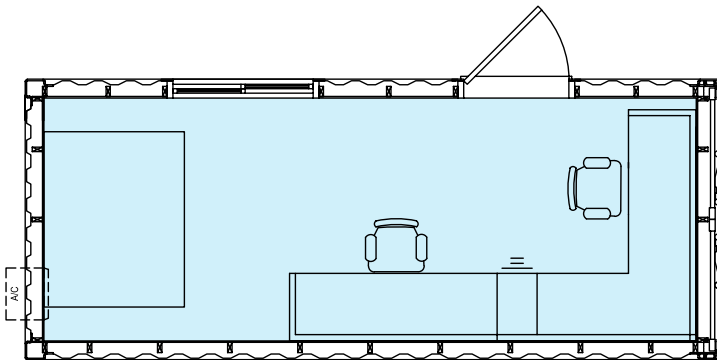

\* Specifications are subject to change. Furniture not included.